

## S-4320 Replacement Latch Kit

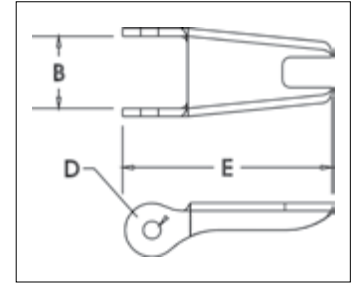

- Heavy duty stamped latch interlocks with the hook tip.
- High cycle, long life spring.
- Can be made into a “Positive Locking” Hook when proper cotter pin is utilized.
- Latch kits shipped unassembled and individually packaged with instructions.
- Meets the intent of OSHA Rule 1926.1431(g) and 1926.1501(g)(when secured with the bolt, nut and pin) for lifting personnel.

**IMPORTANT:** The new S-4320 Latch Kit will not fit the old style 319, 320 and 322 hooks.



APPLICATION AND WARNING INFORMATION  
SECTION 17

4

## S-4320 Replacement Latch Kit for 319N, 320N, 322N, 339N, 1327 and 1339 Hooks

Hook Size (t)			Hook ID Code	Stock No.	Weight Each (lb)	Dimensions (in)		
Carbon	Alloy	Bronze				B	D	E
3/4	1	.5	D	1096325	.03	.50	.15	1.44
1	1-1/2	.6	F	1096374	.04	.54	.17	1.56
1-1/2	2	1	G	1096421	.04	.63	.17	1.66
2	3	1.4	H	1096468	.06	.66	.17	1.91
3	5	2	I	1096515	.10	.83	.20	2.31
5	7	3.5	J	1096562	.15	1.04	.20	2.88
7-1/2	11	5	K	1096609	.28	1.25	.27	3.56
10	15	6.5	L	1096657	.33	1.35	.27	3.81
15	22	10	N	1096704	.84	1.66	.39	5.18

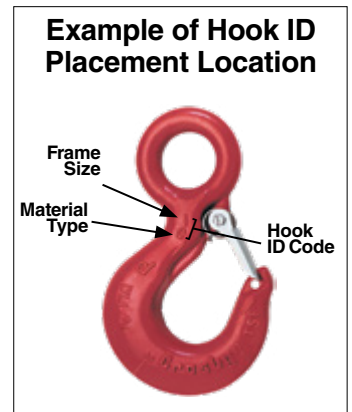

**Raise your world podcast**  
A new podcast for lifting professionals